

**VALVOLA A SFERA - 3 PEZZI - PASSAGGIO TOTALE - ACCIAIO C./INOX - FF - S.800**  
**BALL VALVE - 3 PIECES - FULL BORE - CARBON/STAINLESS ST. - FF - S.800**

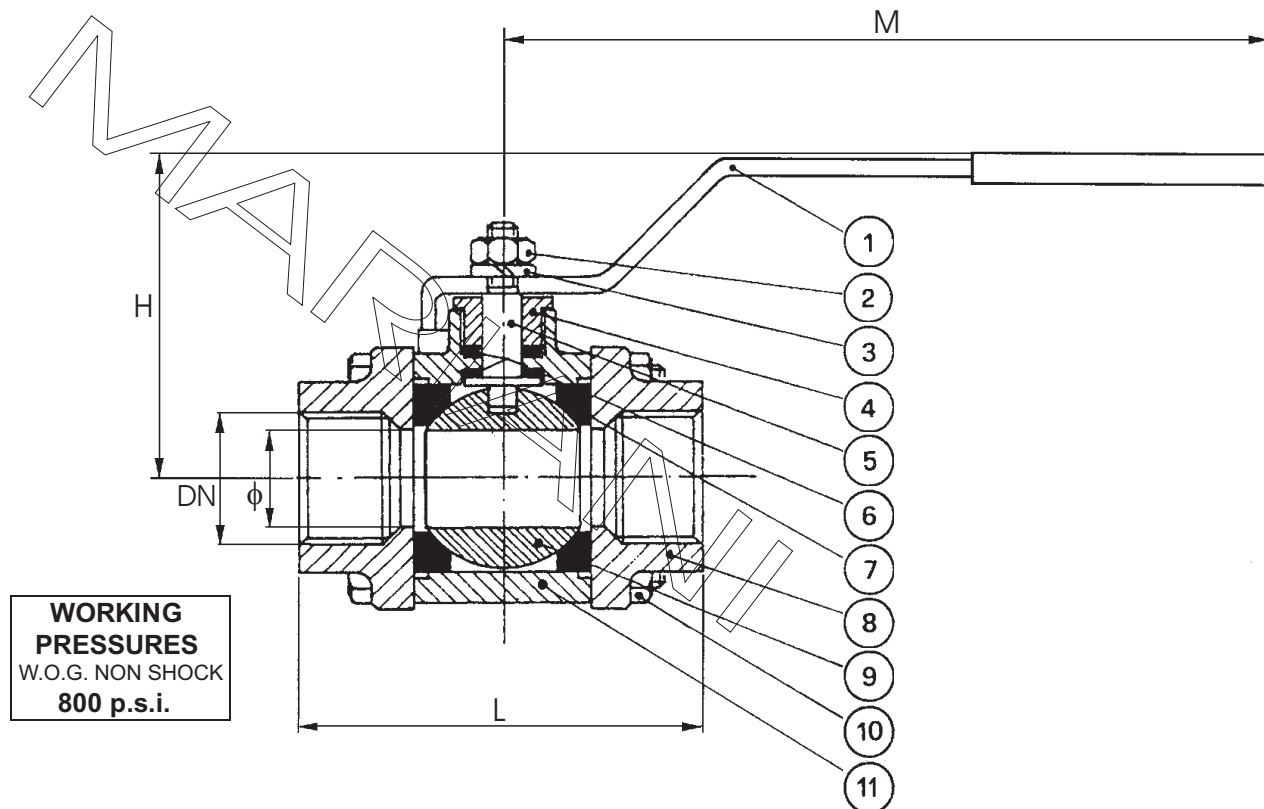

**WORKING PRESSURES**  
W.O.G. NON SHOCK  
**800 p.s.i.**

**OPTIONAL FEATURES:** 1)LOCKING DEVICE  
2)EXTENDED WRENCH  
3)MOUNTING PLATE DIN/ISO 5211  
4)PNEUMATIC/ELECTRIC ACTUATOR  
5)LIMIT SWITCHES

**CONFORM TO:** API STD 6D / BS 5351  
FIRE SAFE API 607 / BS 6755  
ANTISTATIC DEVICE BS 5146  
MSS SP25 / MSS SP110

	DESCRIZIONE	DESCRIPTION	A (Carbon Steel)	INOX (Stainless Steel)
1	LEVA	LEVER	CARBON STEEL	CARBON STEEL
2	DADO	NUT	ASTM A194 2H	ASTM A194 2H
3	PIASTRINA	PLATE	ASTM A182 F304	ASTM A182 F304
4	PREMISTOPPA	THRUST WASHER	ASTM A182 F304	ASTM A182 F304
5	ASTA	STEM	ASTM A182 F304	ASTM A182 F316
6	SEDE ASTA	STEM SEAT	GRAPHITE TEFLONED	GRAPHITE TEFLONED
7	SEGGIO	SEAT	P.T.F.E.	P.T.F.E.
8	MANICOTTO	END PLUG	ASTM A105	ASTM A182 F316
9	SFERA	BALL	ASTM A182 F304	ASTM A182 F316
10	TIRANTE	BOLTING	ASTM A193 B7	ASTM A193 B7
11	CORPO	BODY	ASTM A105	ASTM A182 F316

**THREADING: NPT (ANSI B1.20.1) or GAS (ISO 7/1 Rp) FEMALE PARALLEL**  
**SOLDER ENDS: SW (ANSI B16.11)**

DN	3/8"	1/2"	3/4"	1"	1 1/4"	1 1/2"	2"	2 1/2"	3"	4"
φ	11	14	21	25	32	38	48	65	75	94
L	80	80	96	103	111	131	145	205	210	246
M	130	130	180	180	280	280	280	355	355	410
H	75	75	85	85	100	110	115	145	150	165
Kg	0.600	0.700	1.400	2.200	3.300	4.300	7.300	15	18	23