

**SERPENTINA PORTAMANOMETRO
A 180° IN RAME CROMATO - PN 16
COIL FOR GAUGE - CURLED TYPE
CHROME PLATED COPPER - 100 LBS**

**WORKING
PRESSURES**
W.O.G. NON SHOCK
225 p.s.i.

100

**IN RAME - PN 32
COPPER - 200 LBS**

**WORKING
PRESSURES**
W.O.G. NON SHOCK
450 p.s.i.

101

**IN ACCIAIO C./INOX - PN 100
CARBON/STAINLESS STEEL - 625 LBS**

**WORKING
PRESSURES**
W.O.G. NON SHOCK
2000 p.s.i.

1100

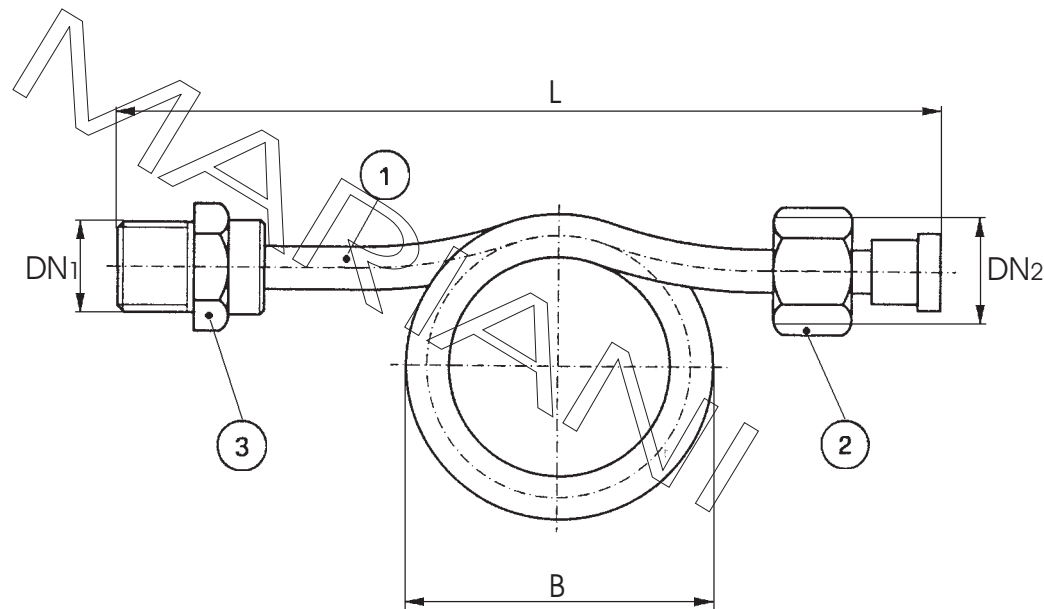

	DESCRIZIONE	DESCRIPTION	100 - 101		
			CU (Copper)	A (Carbon Steel)	INOX (Stainless Steel)
1	TUBO	PIPE	ASTM B124	ASTM A234 WPB	ASTM A182 F316
2	DADO	NUT	BRASS ASTM B16	ASTM A105	ASTM A182 F316
3	NIPPLO	NIPPLE	BRASS ASTM B16	ASTM A105	ASTM A182 F316

THREADING: GAS (ISO 7/1 Rp) FEMALE PARALLEL or NPT (ANSI B.1.20.1)

100

DN1	1/4"	3/8"	1/2"
DN2	1/4"	3/8"	1/2"
L	152	152	152
B	63	63	63
Kg	0.095	0.115	0.145

101

DN1	3/8"	1/2"
DN2	3/8"	1/2"
L	200	202
B	67	67
Kg	0.165	0.235

1100

DN1	1/2"
DN2	1/2"
L	196
B	71
Kg	0.245